

FEATURES

- High end aluminum heatsink with a unique elegant design
- Illuxtron patented optical lens system that makes pin-hole light possible
- Anti glare cap that ensures no stray light. The total light opening is only 8mm!

**Bartenbach**  
lighting optics



SPRINGS

Standard with WS springs (gyproc/metal).  
Also available as above with CS springs (concrete).



COLOURS

Available colours:



Matt white RAL 9016 (XX=MW)  
Matt black RAL 9005 (XX=BL)

# Pointer Spot 68 adj

Adjustable

SPECIFICATIONS

Beam angle (FWHM)	35° (45° FWTM) / 60° (80° FWTM)
Fixture material	Housing: Die cast aluminium
Environment	Indoor
IK rate	IK10
Operating temperature (Ta)	-20°C / +45°C 1
Safety marks	EN60598 / EN62031 / EN62471
EMC compliance	EN55015
Colour consistency (SDCM)	MacAdam step 3
Warranty	7 years * (within the European Union and the countries of the Free Trade Association for products delivered after 1 May 2015)
Energy class	These products contain a light source of energy efficiency class F (2700K/3000K) and class E (4000K)

This luminaire contains built-in LED lamps. There are no exchangeable parts inside the luminaire. EU 874/2012

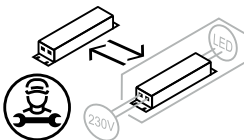

POINTER SPOT 68 ADJ VARIATIONS

Pointer Spot 68 adj LV	CRI93 220-240V	incl. power supply	page 3
Pointer Spot 68 adj LVC	CRI93 500mA	to be connected to a central power supply	page 4
Pointer Spot 68 adj LV	CRI82 220-240V	incl. power supply	page 5
Pointer Spot 68 adj LVC	CRI82 500mA	to be connected to a central power supply	page 6

DIMENSIONS

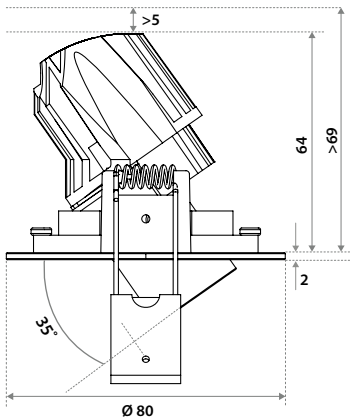

CUT-OUT



Using WS springs: Ø 68-75 mm.  
Thickness ceiling 1-15 mm  
& recess depth 69 mm.



Using CS springs: Ø 68-75 mm.  
Thickness ceiling 5-69 mm  
& recess depth 69 mm.

FIRE RATING TUBE

Description	Item code	Cut-out	time
Fire rating tube 68	009F03MW0000	ø74x71mm	90 min.



⚠ Only in combination with  
WS (wire) springs versions.

ADJUSTMENT OPTIONS

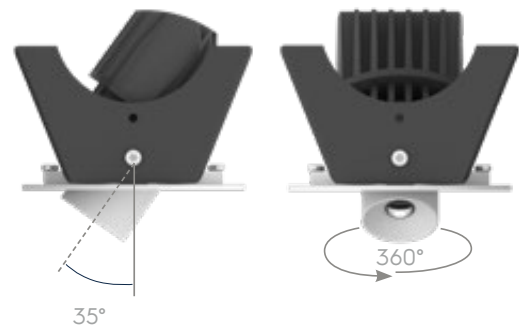

## POINTER SPOT 68 ADJ (dimmable - incl. individual power supply)

**CRI93 / 220-240V**

Downlight incl. PSU

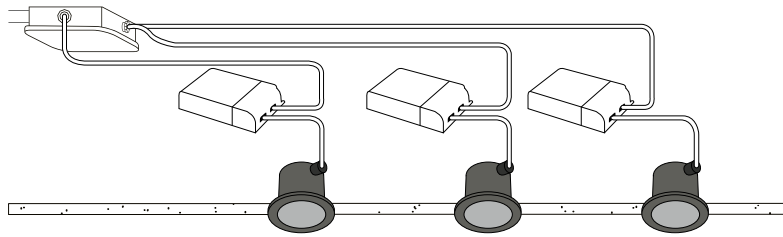
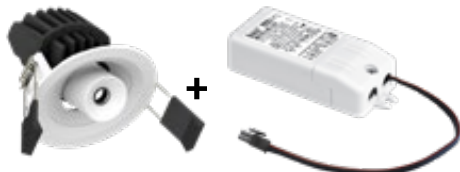

### ITEM SPECIFICATIONS (PART A)

Description	Item code WS	Item code CS	Input	W	Lm	Lm/W	CRI (typ.)	UGR	Pf	Ripple	Inrush current	B-16A Fuse
Pointer Spot 68 adj LV 35° 225 Lm 2700K CRI93 Triac dim	0Q3W03XXWN13	0Q3W03XXLG13	220-240V	6,6	225	34	93	4,4	0,96	<20%	2A 50µS	50 pcs
Pointer Spot 68 adj LV 35° 250 Lm 3000K CRI93 Triac dim	0Q3W03XXWP13	0Q3W03XXLH13	220-240V	6,6	250	38	93	4,8	0,96	<20%	2A 50µS	50 pcs
Pointer Spot 68 adj LV 35° 275 Lm 4000K CRI93 Triac dim	0Q3W03XXWQ13	0Q3W03XXLI13	220-240V	6,6	275	42	93	5,1	0,96	<20%	2A 50µS	50 pcs
Pointer Spot 68 adj LV 60° 375 Lm 2700K CRI93 Triac dim	0Q3W03XXWR13	0Q3W03XXLK13	220-240V	6,6	375	57	93	16,1	0,96	<20%	2A 50µS	50 pcs
Pointer Spot 68 adj LV 60° 400 Lm 3000K CRI93 Triac dim	0Q3W03XXWS13	0Q3W03XXLL13	220-240V	6,6	400	61	93	16,4	0,96	<20%	2A 50µS	50 pcs
Pointer Spot 68 adj LV 60° 425 Lm 4000K CRI93 Triac dim	0Q3W03XXWT13	0Q3W03XXLM13	220-240V	6,6	425	64	93	16,6	0,96	<20%	2A 50µS	50 pcs
Pointer Spot 68 adj LV 35° 225 Lm 2700K CRI93 1-10V & Push	0Q3W03XXXG13	0Q3W03XXWG13	220-240V	6,6	225	34	93	4,4	0,95	<3%	5A 50µS	50 pcs
Pointer Spot 68 adj LV 35° 250 Lm 3000K CRI93 1-10V & Push	0Q3W03XXXH13	0Q3W03XXWH13	220-240V	6,6	250	38	93	4,8	0,95	<3%	5A 50µS	50 pcs
Pointer Spot 68 adj LV 35° 275 Lm 4000K CRI93 1-10V & Push	0Q3W03XXXI13	0Q3W03XXWI13	220-240V	6,6	275	42	93	5,1	0,95	<3%	5A 50µS	50 pcs
Pointer Spot 68 adj LV 60° 375 Lm 2700K CRI93 1-10V & Push	0Q3W03XXXK13	0Q3W03XXWK13	220-240V	6,6	375	57	93	16,1	0,95	<3%	5A 50µS	50 pcs
Pointer Spot 68 adj LV 60° 400 Lm 3000K CRI93 1-10V & Push	0Q3W03XXXL13	0Q3W03XXWL13	220-240V	6,6	400	61	93	16,4	0,95	<3%	5A 50µS	50 pcs
Pointer Spot 68 adj LV 60° 425 Lm 4000K CRI93 1-10V & Push	0Q3W03XXXM13	0Q3W03XXWM13	220-240V	6,6	425	64	93	16,6	0,95	<3%	5A 50µS	50 pcs
Pointer Spot 68 adj LV 35° 225 Lm 2700K CRI93 Dali	0Q3W03XXW013	0Q3W03XXL013	220-240V	6,6	225	34	93	4,4	0,95	<3%	5A 50µS	50 pcs
Pointer Spot 68 adj LV 35° 250 Lm 3000K CRI93 Dali	0Q3W03XXW113	0Q3W03XXL113	220-240V	6,6	250	38	93	4,8	0,95	<3%	5A 50µS	50 pcs
Pointer Spot 68 adj LV 35° 275 Lm 4000K CRI93 Dali	0Q3W03XXW213	0Q3W03XXL213	220-240V	6,6	275	42	93	5,1	0,95	<3%	5A 50µS	50 pcs
Pointer Spot 68 adj LV 60° 375 Lm 2700K CRI93 Dali	0Q3W03XXW313	0Q3W03XXL313	220-240V	6,6	375	57	93	16,1	0,95	<3%	5A 50µS	50 pcs
Pointer Spot 68 adj LV 60° 400 Lm 3000K CRI93 Dali	0Q3W03XXW413	0Q3W03XXL413	220-240V	6,6	400	61	93	16,4	0,95	<3%	5A 50µS	50 pcs
Pointer Spot 68 adj LV 60° 425 Lm 4000K CRI93 Dali	0Q3W03XXW513	0Q3W03XXL513	220-240V	6,6	425	64	93	16,6	0,95	<3%	5A 50µS	50 pcs

### ITEM SPECIFICATIONS (PART B)

Description	Safety class	Energy class	Weight	Dimensions single carton	Quantity per carton	Expected Lifetime			Reported Lifetime*		
						L70B10	L80B10	L90B10	L70B10	L80B10	L90B10
Pointer Spot 68 adj LV 2700K CRI93	II	F	276 gr	105x105x61 mm	42 pcs	177.000 hrs	113.000 hrs	51.000 hrs	>102.000 hrs	>102.000 hrs	51.000 hrs
Pointer Spot 68 adj LV 3000K CRI93	II	F	276 gr	105x105x61 mm	42 pcs	177.000 hrs	113.000 hrs	51.000 hrs	>102.000 hrs	>102.000 hrs	51.000 hrs
Pointer Spot 68 adj LV 4000K CRI93	II	E	276 gr	105x105x61 mm	42 pcs	177.000 hrs	113.000 hrs	51.000 hrs	>102.000 hrs	>102.000 hrs	51.000 hrs

All values are measured at 230V (+/- 7%). \*Based on 17.000hrs of LM80 testing at 700mA and a Tc85 °C.

### INCL. PSU

PSU TCI 127042 Triac dim	102x38x21 mm
PSU TCI 123400 1-10V & Push	102x38x21 mm
PSU TCI 142014 Dali	147x44x22 mm



**POINTER SPOT 68 ADJ** (dimmable - excl. central power supply)

**CRI93 / 500 mA**

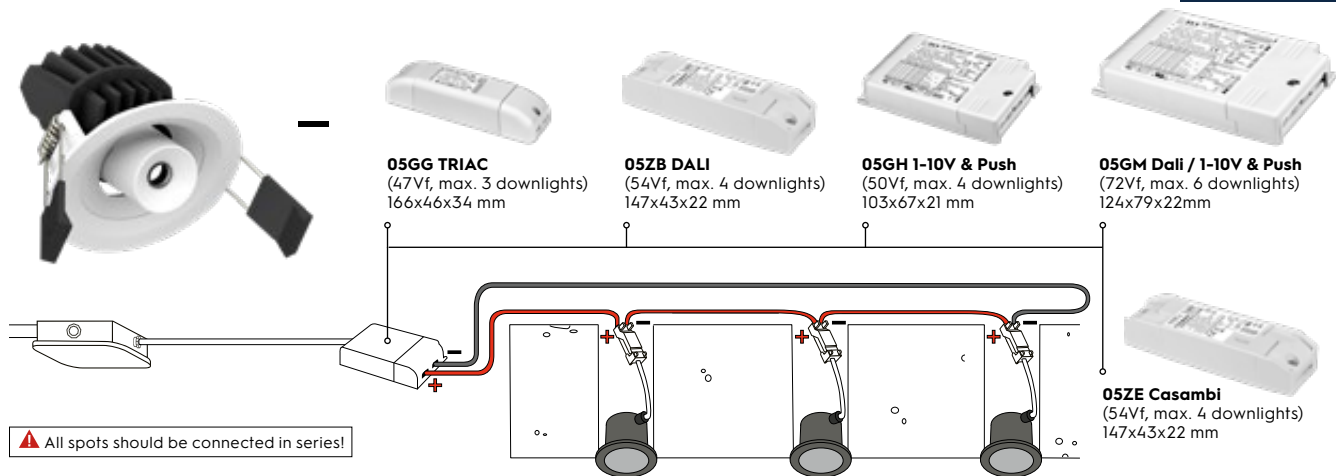

**ITEM SPECIFICATIONS (PART A)**

Description	Item code WS	Item code CS	Input	Vf	W	Lm	Lm/W	CRI (typ.)	UGR	Pf	Ripple	Inrush current	B-16A Fuse
Pointer Spot 68 adj LVC 500mA 35° 225 Lm 2700K CRI93	0Q3W03XXWN11	0Q3W03XXLG11	500mA	11,4	5,7	225	39	93	4,4	x	x	x	x
Pointer Spot 68 adj LVC 500mA 35° 250 Lm 3000K CRI93	0Q3W03XXWP11	0Q3W03XXLH11	500mA	11,4	5,7	250	44	93	4,8	x	x	x	x
Pointer Spot 68 adj LVC 500mA 35° 275 Lm 4000K CRI93	0Q3W03XXWQ11	0Q3W03XXLJ11	500mA	11,4	5,7	275	48	93	5,1	x	x	x	x
Pointer Spot 68 adj LVC 500mA 60° 375 Lm 2700K CRI93	0Q3W03XXWR11	0Q3W03XXLK11	500mA	11,4	5,7	375	66	93	16,1	x	x	x	x
Pointer Spot 68 adj LVC 500mA 60° 400 Lm 3000K CRI93	0Q3W03XXWS11	0Q3W03XXLL11	500mA	11,4	5,7	400	70	93	16,4	x	x	x	x
Pointer Spot 68 adj LVC 500mA 60° 425 Lm 4000K CRI93	0Q3W03XXWT11	0Q3W03XXLM11	500mA	11,4	5,7	425	75	93	16,6	x	x	x	x

**ITEM SPECIFICATIONS (PART B)**

Description	Safety class	Energy class	Weight	Dimensions single carton	Quantity per carton	Expected Lifetime			Reported Lifetime*		
						L70B10	L80B10	L90B10	L70B10	L80B10	L90B10
Pointer Spot 68 adj LVC 500mA CRI93	III	F	226 gr	105x105x61 mm	42 pcs	177.000 hrs	113.000 hrs	51.000 hrs	>102.000 hrs	>102.000 hrs	51.000 hrs
Pointer Spot 68 adj LVC 500mA CRI93	III	F	226 gr	105x105x61 mm	42 pcs	177.000 hrs	113.000 hrs	51.000 hrs	>102.000 hrs	>102.000 hrs	51.000 hrs
Pointer Spot 68 adj LVC 500mA CRI93	III	E	226 gr	105x105x61 mm	42 pcs	177.000 hrs	113.000 hrs	51.000 hrs	>102.000 hrs	>102.000 hrs	51.000 hrs

**ITEM SPECIFICATIONS (PSU)**

Description	Item code	Input	Watt	Current	Efficiency	Pf	Ripple	Weight	Inrush current	B-16A Fuse
PSU 24W 500mA Triac	05GG03MLME00	220-240V	24W (47Vf)	500mA	85%	0,97	<3%	138 gr	5A 50µS	50 pcs
PSU 27W 500mA Dali	05ZB03MLME00	220-240V	27W (54Vf)	500mA	89%	0,95	<3%	139 gr	5A 50µS	50 pcs
PSU 25W 500mA 1-10V & Push	05GH03MLME00	220-240V	25W (50Vf)	500mA	88%	0,95	<3%	138 gr	5A 50µS	50 pcs
PSU 27W 500mA Casambi	05ZE03MLME00	220-240V	27W (54Vf)	500mA	89%	0,95	<3%	139 gr	5A 50µS	50 pcs
PSU 35W 500mA Dali / 1-10V & Push	05GM03MLME00	220-240V	35W (72Vf)	500mA	89%	0,95	<3%	218 gr	10A 200µS	30 pcs

All values are measured at 230V (+/- 7%). \*Based on 17.000hrs of LM80 testing at 700mA and a Tc85 °C.

**INCLUDING CONNECTION BOX**

For installation to a central power supply.

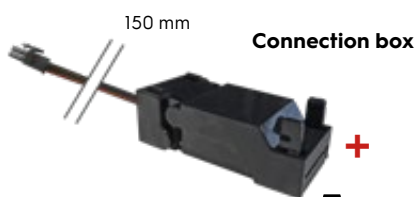

## POINTER SPOT 68 ADJ (dimmable - incl. individual power supply)

**CRI82 / 220-240V**

Downlight incl. PSU

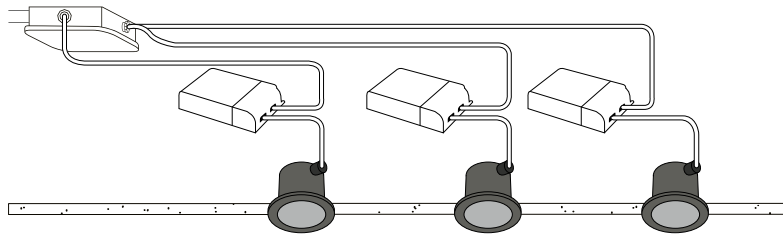
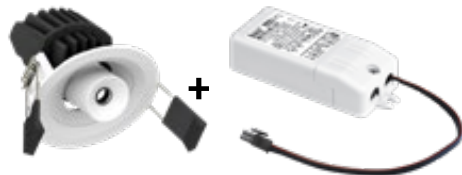

### ITEM SPECIFICATIONS (PART A)

Description	Item code WS	Item code CS	Input	W	Lm	Lm/W	CRI (typ.)	UGR	Pf	Ripple	Inrush current	B-16A Fuse
Pointer Spot 68 adj LV 35° 350 Lm 2700K CRI82 Triac dim	0Q2703XXWN13	0Q2703XXLG13	220-240V	6,6	350	53	82	6.7	0.96	<20%	2A 50μS	50 pcs
Pointer Spot 68 adj LV 35° 375 Lm 3000K CRI82 Triac dim	0Q2703XXWP13	0Q2703XXLH13	220-240V	6,6	375	57	82	6.9	0.96	<20%	2A 50μS	50 pcs
Pointer Spot 68 adj LV 35° 400 Lm 4000K CRI82 Triac dim	0Q2703XXWQ13	0Q2703XXLI13	220-240V	6,6	400	61	82	7.2	0.96	<20%	2A 50μS	50 pcs
Pointer Spot 68 adj LV 60° 400 Lm 2700K CRI82 Triac dim	0Q2703XXWR13	0Q2703XXLK13	220-240V	6,6	400	61	82	17.1	0.96	<20%	2A 50μS	50 pcs
Pointer Spot 68 adj LV 60° 425 Lm 3000K CRI82 Triac dim	0Q2703XXWS13	0Q2703XXLL13	220-240V	6,6	425	64	82	17.3	0.96	<20%	2A 50μS	50 pcs
Pointer Spot 68 adj LV 60° 450 Lm 4000K CRI82 Triac dim	0Q2703XXWT13	0Q2703XXLM13	220-240V	6,6	450	68	82	17.5	0.96	<20%	2A 50μS	50 pcs
Pointer Spot 68 adj LV 35° 350 Lm 2700K CRI82 1-10V & Push	0Q2703XXXG13	0Q2703XXWG13	220-240V	6,6	350	53	82	6.7	0.95	<3%	5A 50μS	50 pcs
Pointer Spot 68 adj LV 35° 375 Lm 3000K CRI82 1-10V & Push	0Q2703XXXH13	0Q2703XXWH13	220-240V	6,6	375	57	82	6.9	0.95	<3%	5A 50μS	50 pcs
Pointer Spot 68 adj LV 35° 400 Lm 4000K CRI82 1-10V & Push	0Q2703XXXI13	0Q2703XXWI13	220-240V	6,6	400	61	82	7.2	0.95	<3%	5A 50μS	50 pcs
Pointer Spot 68 adj LV 60° 400 Lm 2700K CRI82 1-10V & Push	0Q2703XXXK13	0Q2703XXWK13	220-240V	6,6	400	61	82	17.1	0.95	<3%	5A 50μS	50 pcs
Pointer Spot 68 adj LV 60° 425 Lm 3000K CRI82 1-10V & Push	0Q2703XXXL13	0Q2703XXWL13	220-240V	6,6	425	64	82	17.3	0.95	<3%	5A 50μS	50 pcs
Pointer Spot 68 adj LV 60° 450 Lm 4000K CRI82 1-10V & Push	0Q2703XXXM13	0Q2703XXWM13	220-240V	6,6	450	68	82	17.5	0.95	<3%	5A 50μS	50 pcs
Pointer Spot 68 adj LV 35° 350 Lm 2700K CRI82 Dali	0Q2703XXW013	0Q2703XXL013	220-240V	6,6	350	53	82	6.7	0.95	<3%	5A 50μS	50 pcs
Pointer Spot 68 adj LV 35° 375 Lm 3000K CRI82 Dali	0Q2703XXW113	0Q2703XXL113	220-240V	6,6	375	57	82	6.9	0.95	<3%	5A 50μS	50 pcs
Pointer Spot 68 adj LV 35° 400 Lm 4000K CRI82 Dali	0Q2703XXW213	0Q2703XXL213	220-240V	6,6	400	61	82	7.2	0.95	<3%	5A 50μS	50 pcs
Pointer Spot 68 adj LV 60° 400 Lm 2700K CRI82 Dali	0Q2703XXW313	0Q2703XXL313	220-240V	6,6	400	61	82	17.1	0.95	<3%	5A 50μS	50 pcs
Pointer Spot 68 adj LV 60° 425 Lm 3000K CRI82 Dali	0Q2703XXW413	0Q2703XXL413	220-240V	6,6	425	64	82	17.3	0.95	<3%	5A 50μS	50 pcs
Pointer Spot 68 adj LV 60° 450 Lm 4000K CRI82 Dali	0Q2703XXW513	0Q2703XXL513	220-240V	6,6	450	68	82	17.5	0.95	<3%	5A 50μS	50 pcs

### ITEM SPECIFICATIONS (PART B)

Description	Safety class	Energy class	Weight	Dimensions single carton	Quantity per carton	Expected Lifetime B10 reported (25°C)		
Pointer Spot 68 adj LV 2700K CRI82	II	F	276 gr	105x105x61 mm	42 pcs	L70B10	L80B10	L90B10
Pointer Spot 68 adj LV 3000K CRI82	II	F	276 gr	105x105x61 mm	42 pcs	>60.000 hrs	>60.000 hrs	>60.000 hrs
Pointer Spot 68 adj LV 4000K CRI82	II	E	276 gr	105x105x61 mm	42 pcs	>60.000 hrs	>60.000 hrs	>60.000 hrs

All values are measured at 230V (+/- 7%)

### INCL. PSU

PSU TCI 127042 Triac dim	102x38x21 mm
PSU TCI 123400 1-10V & Push	102x38x21 mm
PSU TCI 142014 Dali	147x44x22 mm



**POINTER SPOT 68 ADJ** (dimmable - excl. central power supply)

**CRI82 / 500 mA**

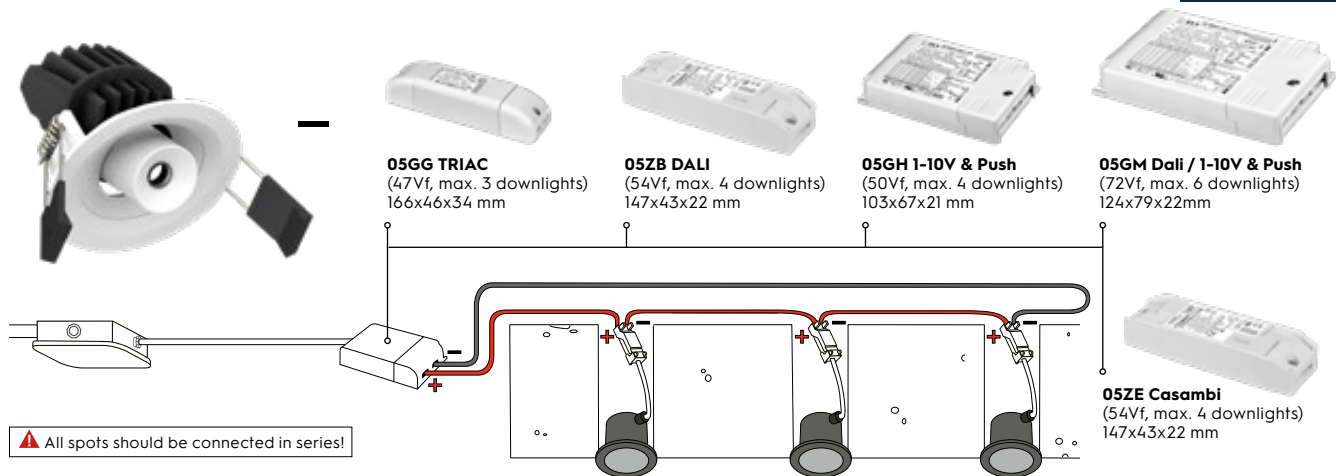

**ITEM SPECIFICATIONS (PART A)**

Description	Item code WS	Item code CS	Input	Vf	W	Lm	Lm/W	CRI (typ.)	UGR	Pf	Ripple	Inrush current	B-16A Fuse
Pointer Spot 68 adj LVC 500mA 35° 350 Lm 2700K CRI82	0Q2703XXWNII	0Q2703XXLGII	500mA	11,4	5,7	350	61	82	61	x	x	x	x
Pointer Spot 68 adj LVC 500mA 35° 375 Lm 3000K CRI82	0Q2703XXWP1I	0Q2703XXLH1I	500mA	11,4	5,7	375	66	82	66	x	x	x	x
Pointer Spot 68 adj LVC 500mA 35° 400 Lm 4000K CRI82	0Q2703XXWQ1I	0Q2703XXLJ1I	500mA	11,4	5,7	400	70	82	70	x	x	x	x
Pointer Spot 68 adj LVC 500mA 60° 400 Lm 2700K CRI82	0Q2703XXWR1I	0Q2703XXLK1I	500mA	11,4	5,7	400	70	82	70	x	x	x	x
Pointer Spot 68 adj LVC 500mA 60° 425 Lm 3000K CRI82	0Q2703XXWS1I	0Q2703XXLL1I	500mA	11,4	5,7	425	75	82	75	x	x	x	x
Pointer Spot 68 adj LVC 500mA 60° 450 Lm 4000 CRI82 K	0Q2703XXWT1I	0Q2703XXLM1I	500mA	11,4	5,7	450	79	82	79	x	x	x	x

**ITEM SPECIFICATIONS (PART B)**

Description	Safety class	Energy class	Weight	Dimensions single carton	Quantity per carton	Expected Lifetime B10 reported (25°C)		
						L70B10	L80B10	L90B10
Pointer Spot 68 adj LVC 500mA 2700K CRI82	III	F	226 gr	105x105x61 mm	42 pcs	>60.000 hrs	>60.000 hrs	>60.000 hrs
Pointer Spot 68 adj LVC 500mA 3000K CRI82	III	F	226 gr	105x105x61 mm	42 pcs	>60.000 hrs	>60.000 hrs	>60.000 hrs
Pointer Spot 68 adj LVC 500mA 4000K CRI82	III	E	226 gr	105x105x61 mm	42 pcs	>60.000 hrs	>60.000 hrs	>60.000 hrs

**ITEM SPECIFICATIONS (PSU)**

Description	Item code	Input	Watt	Current	Efficiency	Pf	Ripple	Weight	Inrush current	B-16A Fuse
PSU 24W 500mA Triac	05GG03MLME00	220-240V	24W (47Vf)	500mA	85%	0.97	<3%	138 gr	5A 50µS	50 pcs
PSU 27W 500mA Dali	05ZB03MLME00	220-240V	27W (54Vf)	500mA	89%	0.95	<3%	139 gr	5A 50µS	50 pcs
PSU 25W 500mA 1-10V & Push	05GH03MLME00	220-240V	25W (50Vf)	500mA	88%	0.95	<3%	138 gr	5A 50µS	50 pcs
PSU 27W 500mA Casambi	05ZE03MLME00	220-240V	27W (54Vf)	500mA	89%	0.95	<3%	139 gr	5A 50µS	50 pcs
PSU 35W 500mA Dali / 1-10V & Push	05GM03MLME00	220-240V	35W (72Vf)	500mA	89%	0.95	<3%	218 gr	10A 200µS	30 pcs

All values are measured at 230V (+/- 7%)

**INCLUDING CONNECTION BOX**

For installation to a central power supply.

